

LAMP POST SPECIFICATIONS

STYLE: HANCOCK INTERNAL WITH LADDER REST
 HEIGHT: 10'-2"
 BASE: 16" DIAMETER
 MATERIAL: PLEASE ADVISE BELOW
 FINISH: PLEASE ADVISE BELOW
 ACCESS DOOR: LOCATED IN BASE SECURED WITH TAMPER PROOF HEX SOCKET SECURITY MACHINE SCREWS
 GROUND PROVISIONS: DRILL AND TAP INSIDE WALL OF BASE OPPOSITE ACCESS DOOR TO ACCOMMODATE A 1/4"-20 GROUND STUD (STUD SUPPLIED BY OTHERS)
 ANCHOR BOLTS: (4) 3/4" DIA. X 24" LONG + 3" HOOK (FULLY GALVANIZED WITH 1 GALVANIZED NUT AND 1 GALVANIZED WASHER PER BOLT)
 BOLT PROJECTION: 3" REQUIRED
 TENON: PLEASE ADVISE BELOW
 CATALOG NO.: PSNHC-16-10.17-LR-TN- / -C-

| MATERIAL | CAT. NO. |
|---|----------|
| 1 PIECE, CAST ALUMINUM ALLOY ANSI 356 PER A.S.T.M. B26-95 | A |
| 1 PIECE, CAST IRON PER A.S.T.M. A48-83 CLASS 30 | I |
| 1 PIECE, CAST DUCTILE IRON PER A536-84 GRADE 65-45-12 | D |

| TENON | CAT. NO. |
|-------------------------|-------------|
| 2 7/8" DIA. X 3" HIGH | TN2.88/3.00 |
| 3" DIA. X 3" HIGH | TN3.00/3.00 |
| 3 1/2" DIA. X 3" HIGH | TN3.50/3.00 |
| 4" DIA. X 3" HIGH | TN4.00/3.00 |
| X.XX" DIA. X X.XX" HIGH | TNX.XX/X.XX |

| FINISH | CAT. NO. |
|--|----------|
| POWDER COAT - PLEASE ADVISE RAL # | CU |
| PRIME PAINT THEN FINISH PAINT SHERWIN WILLIAMS - PLEASE ADVISE COLOR | CW |

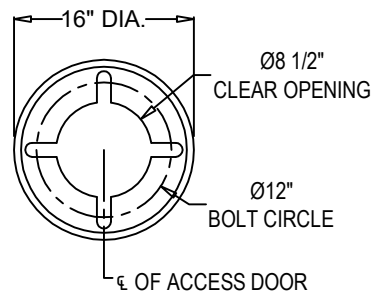
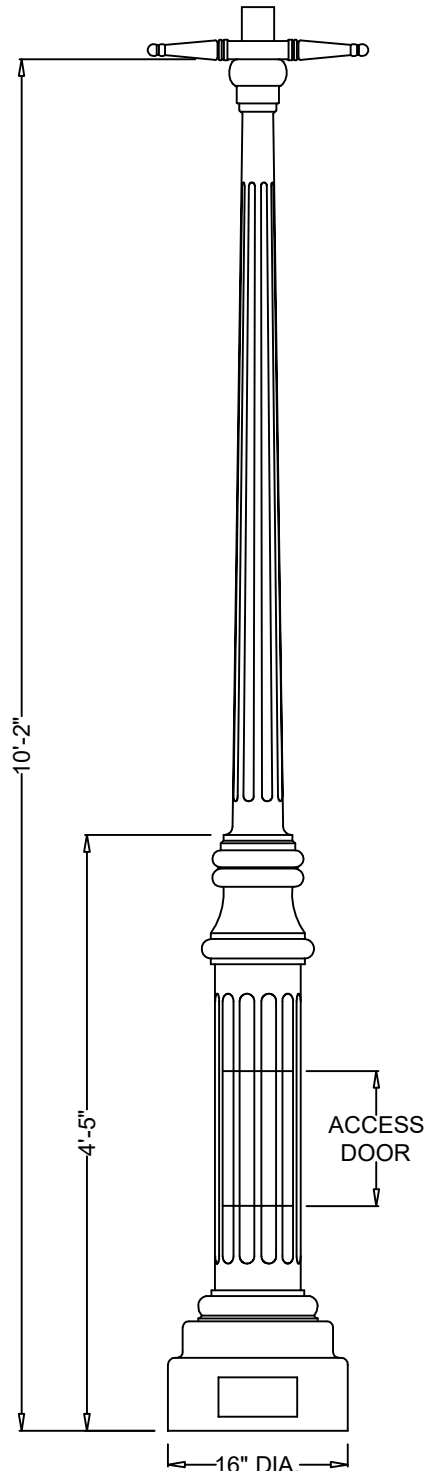

BASE PLATE DETAIL



Spring City Electrical Mfg. Co.

HALL AND MAIN STREETS - P.O. BOX 19 - SPRING CITY, PA. 19475
 PHONE (610) 948-4000 - FAX (610) 948-5577 - WWW.SPRINGCITY.COM

DESCRIPTION

THE HANCOCK WITH LADDER REST
 10'-2" LAMP POST